



## HACIENDA DEL SOL

- Homes only community with underground electric
- Large lots on cul-de-sacs adjacent to large open spaces
- 1500 sq. ft. minimum house size; 1200 sq. ft. minimum interior + 300 sq. ft. minimum exterior
- Styles of homes can be Southwestern, Mediterranean or Mexican hacienda

- 10 foot setbacks from all four sides of the lot
- 15 foot height limit for all houses (+3.3 ft. for chimney)

- 4 foot height limit for front & rear fences
- 5 foot height limit for side fences



# HACIENDA DEL SOL

7400 - SECTIONS I to Vb  
2005 • 447



THIS MAP IS FOR GENERAL LOT LOCATION USE ONLY  
ARCHITECT - JORGE PONCE © • ARTWORK® - BOB SKYE  
COPY BY WRITTEN PERMISSION ONLY

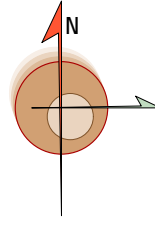

## HACIENDA DEL SOL

- Homes only community with underground electric
- Large lots on cul-de-sacs adjacent to large open spaces
- 1500 sq. ft. minimum house size; 1200 sq. ft. minimum interior + 300 sq. ft. minimum exterior
- Styles of homes can be Southwestern, Mediterranean or Mexican hacienda
- 10 foot setbacks from all four sides of the lot
- 15 foot height limit for all houses (+3.3 ft. for chimney)
- 4 foot height limit for front & rear fences - 5 foot height limit for side fences
- Annual Maintenance fees - \$725 per year (\$60.42 per month)

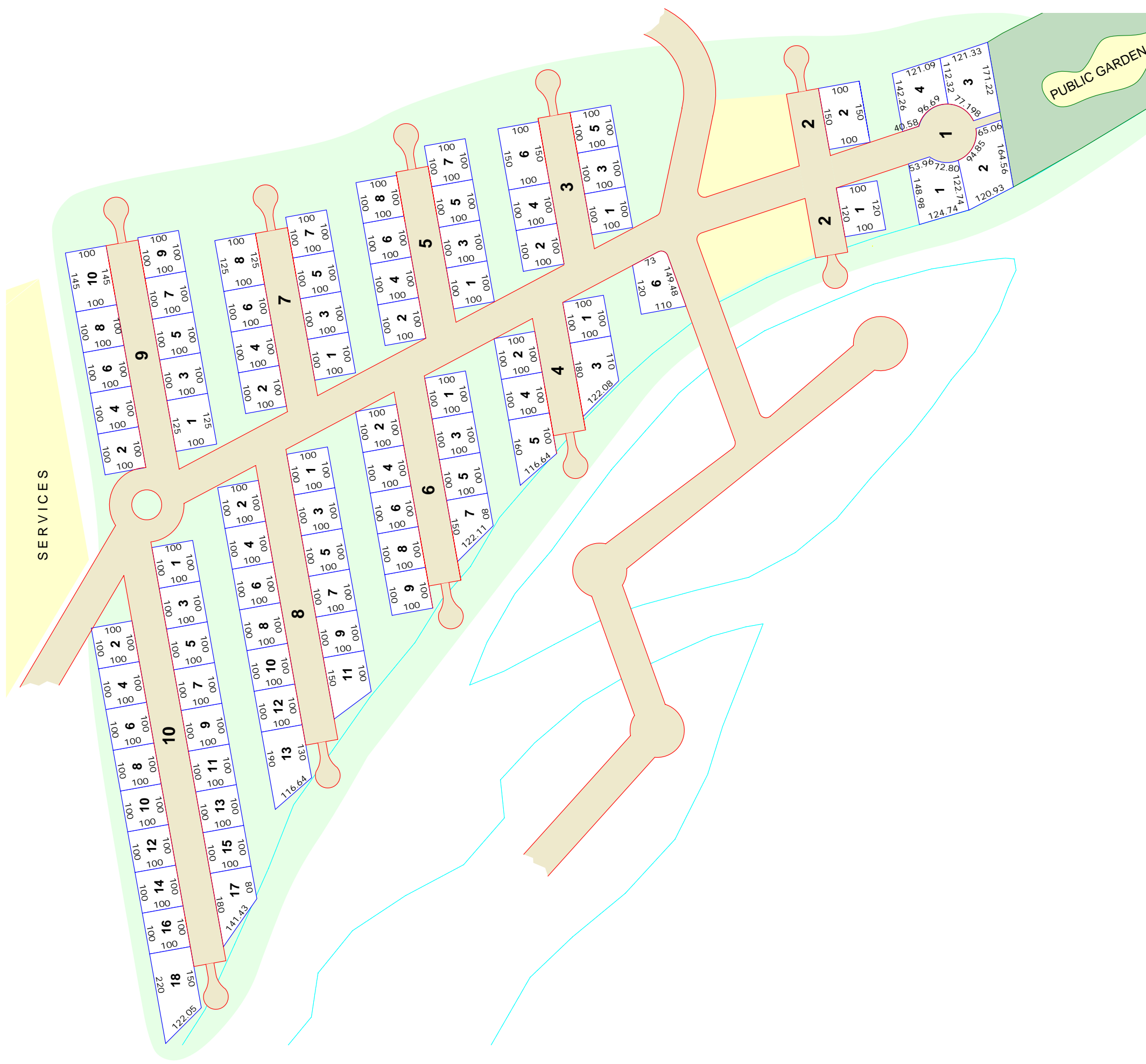

## HACIENDA DEL SOL

7400 - SECTION I  
1Q-2005 • 84



THIS MAP IS FOR GENERAL LOT LOCATION USE ONLY  
ARCHITECT - JORGE PONCE © • ARTWORK® - BOB SKYE  
COPY BY WRITTEN PERMISSION ONLY

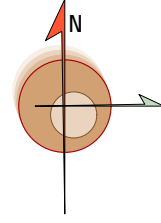

## HACIENDA DEL SOL

- Homes only community with underground electric
- Large lots on cul-de-sacs adjacent to large open spaces
- 1500 sq. ft. minimum house size; 1200 sq. ft. minimum interior + 300 sq. ft. minimum exterior
- Styles of homes can be Southwestern, Mediterranean or Mexican hacienda
- 10 foot setbacks from all four sides of the lot
- 15 foot height limit for all houses (+3.3 ft. for chimney)
- 4 foot height limit for front & rear fences - 5 foot height limit for side fences
- Annual Maintenance fees - \$725 per year (\$60.42 per month)

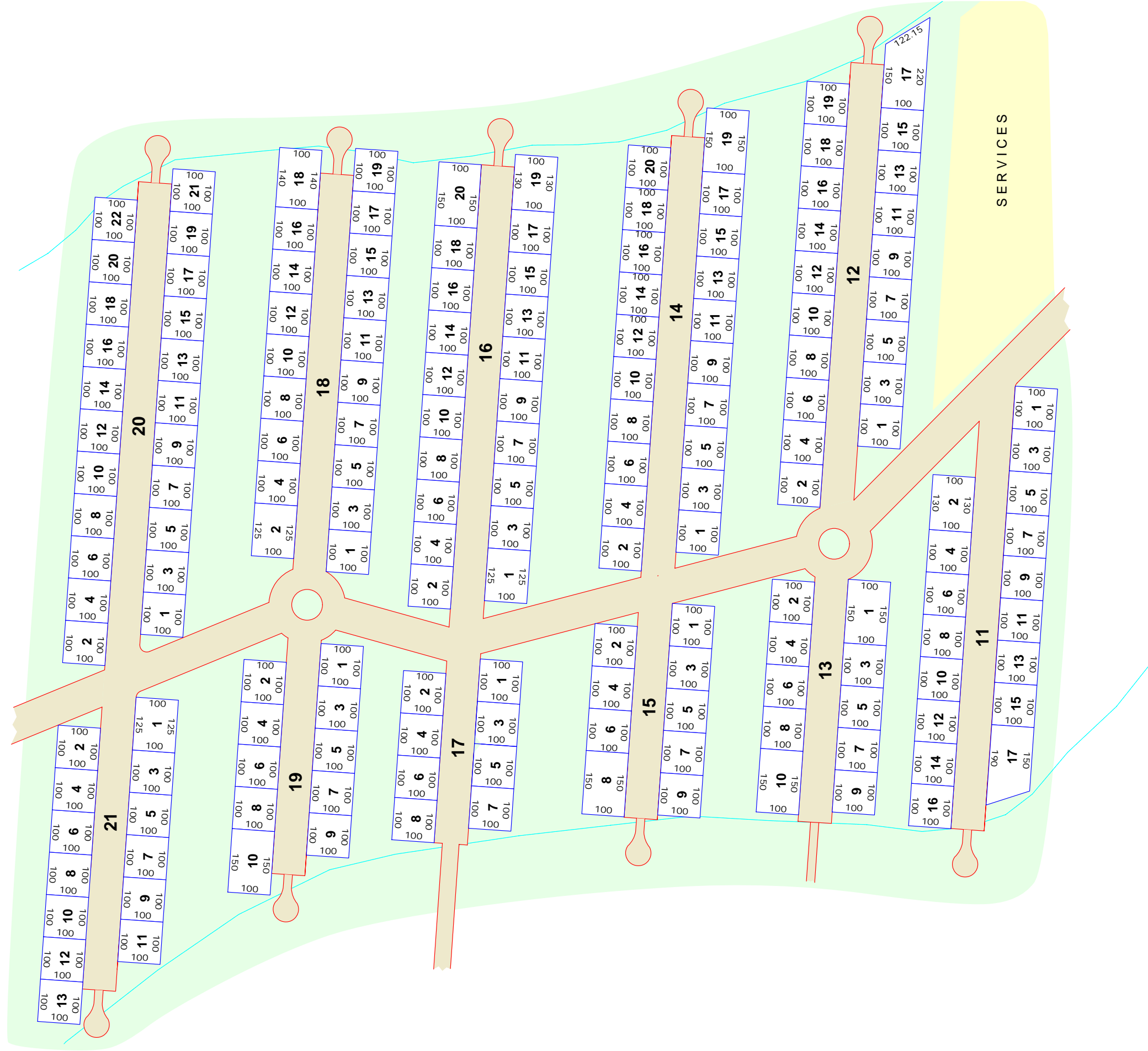

## HACIENDA DEL SOL

7400 - SECTION II  
2Q-2005 • 167



*El Dorado Ranch • Baja California*

THIS MAP IS FOR GENERAL LOT LOCATION USE ONLY  
ARCHITECT - JORGE PONCE • ARTWORK® - BOB SKYE  
COPY BY WRITTEN PERMISSION ONLY

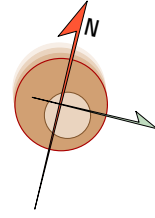

## HACIENDA DEL SOL

- Homes only community with underground electric
- Large lots on cul-de-sacs adjacent to large open spaces
- 1500 sq. ft. minimum house size; 1200 sq. ft. minimum interior + 300 sq. ft. minimum exterior
- Styles of homes can be Southwestern, Mediterranean or Mexican hacienda
- 10 foot setbacks from all four sides of the lot
- 15 foot height limit for all houses (+3.3 ft. for chimney)
- 4 foot height limit for front & rear fences - 5 foot height limit for side fences
- Annual Maintenance fees - \$725 per year (\$60.42 per month)

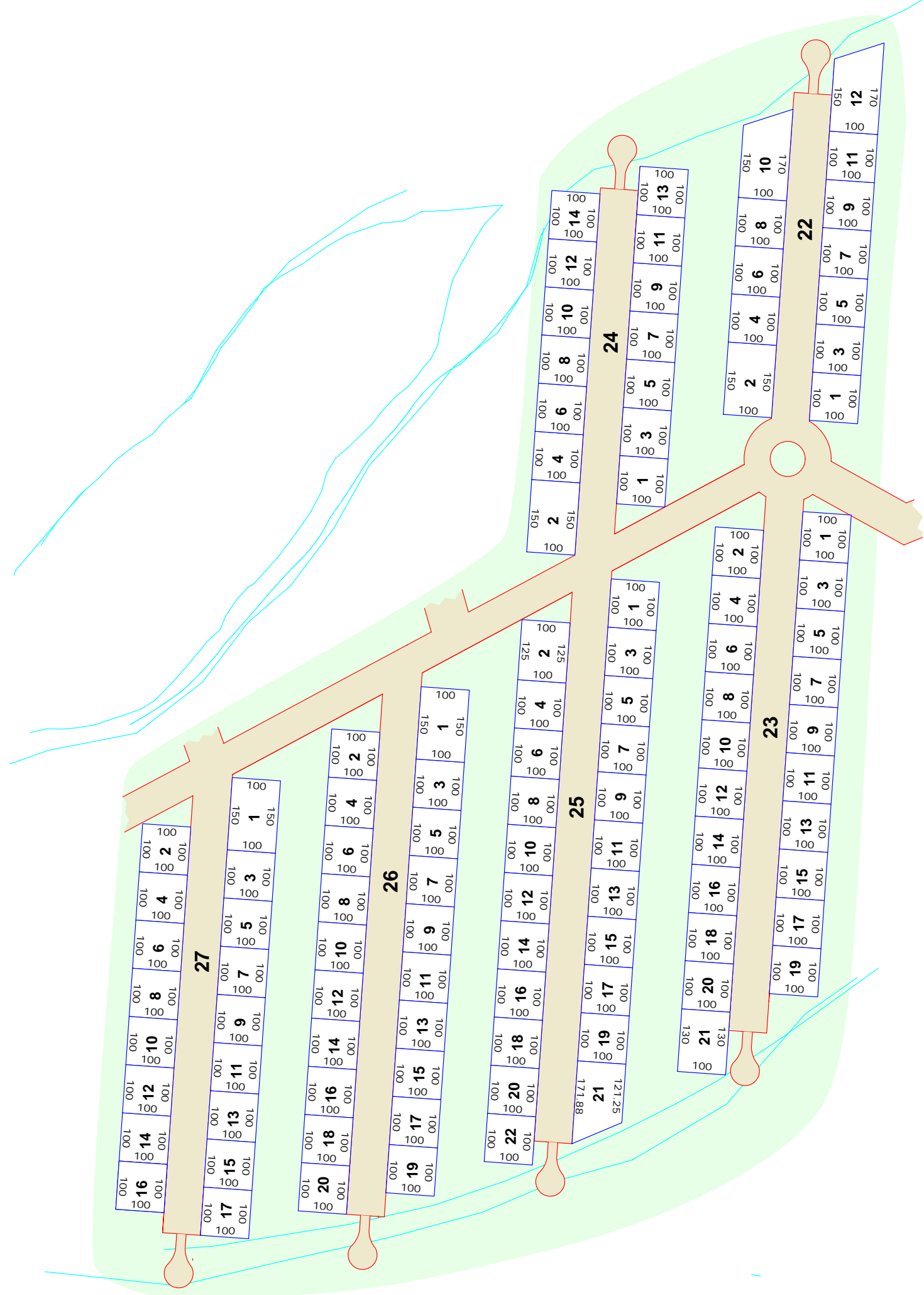

## HACIENDA DEL SOL

7400 - SECTION III  
3Q-2005 • 106



*El Dorado Ranch • Baja California*

THIS MAP IS FOR GENERAL LOT LOCATION USE ONLY  
ARCHITECT - JORGE PONCE © • ARTWORK® - BOB SKYE  
COPY BY WRITTEN PERMISSION ONLY

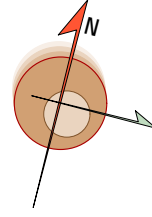

## HACIENDA DEL SOL

- Homes only community with underground electric
- Large lots on cul-de-sacs adjacent to large open spaces
- 1500 sq. ft. minimum house size; 1200 sq. ft. minimum interior + 300 sq. ft. minimum exterior
- Styles of homes can be Southwestern, Mediterranean or Mexican hacienda
- 15 foot setbacks from all four sides of the lot
- 15 foot height limit for all houses (+3.3 ft. for chimney)
- 4 foot height limit for front & rear fences - 5 foot height limit for side fences



## HACIENDA DEL SOL

7400 - SECTION IV  
4Q-2005 • 23

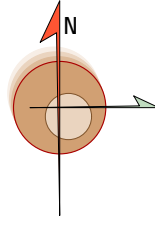

## HACIENDA DEL SOL

- Homes only community with underground electric
- Large lots on cul-de-sacs adjacent to large open spaces
- 1500 sq. ft. minimum house size; 1200 sq. ft. minimum interior + 300 sq. ft. minimum exterior
- Styles of homes can be Southwestern, Mediterranean or Mexican hacienda
- 10 foot setbacks from all four sides of the lot
- 15 foot height limit for all houses (+3.3 ft. for chimney)
- 4 foot height limit for front & rear fences - 5 foot height limit for side fences
- Annual Maintenance fees - \$725 per year (\$60.42 per month)



## HACIENDA DEL SOL

7400 - SECTION VA  
4Q-2005 • 43



*El Dorado Ranch • Baja California*

THIS MAP IS FOR GENERAL LOT LOCATION USE ONLY  
ARCHITECT - JORGE PONCE © • ARTWORK® - BOB SKYE  
COPY BY WRITTEN PERMISSION ONLY

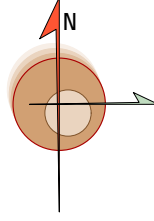

## HACIENDA DEL SOL

- Homes only community with underground electric
- Large lots on cul-de-sacs adjacent to large open spaces
- 1500 sq. ft. minimum house size; 1200 sq. ft. minimum interior + 300 sq. ft. minimum exterior
- Styles of homes can be Southwestern, Mediterranean or Mexican hacienda
- 10 foot setbacks from all four sides of the lot
- 15 foot height limit for all houses (+3.3 ft. for chimney)
- 4 foot height limit for front & rear fences - 5 foot height limit for side fences
- Annual Maintenance fees - \$725 per year (\$60.42 per month)

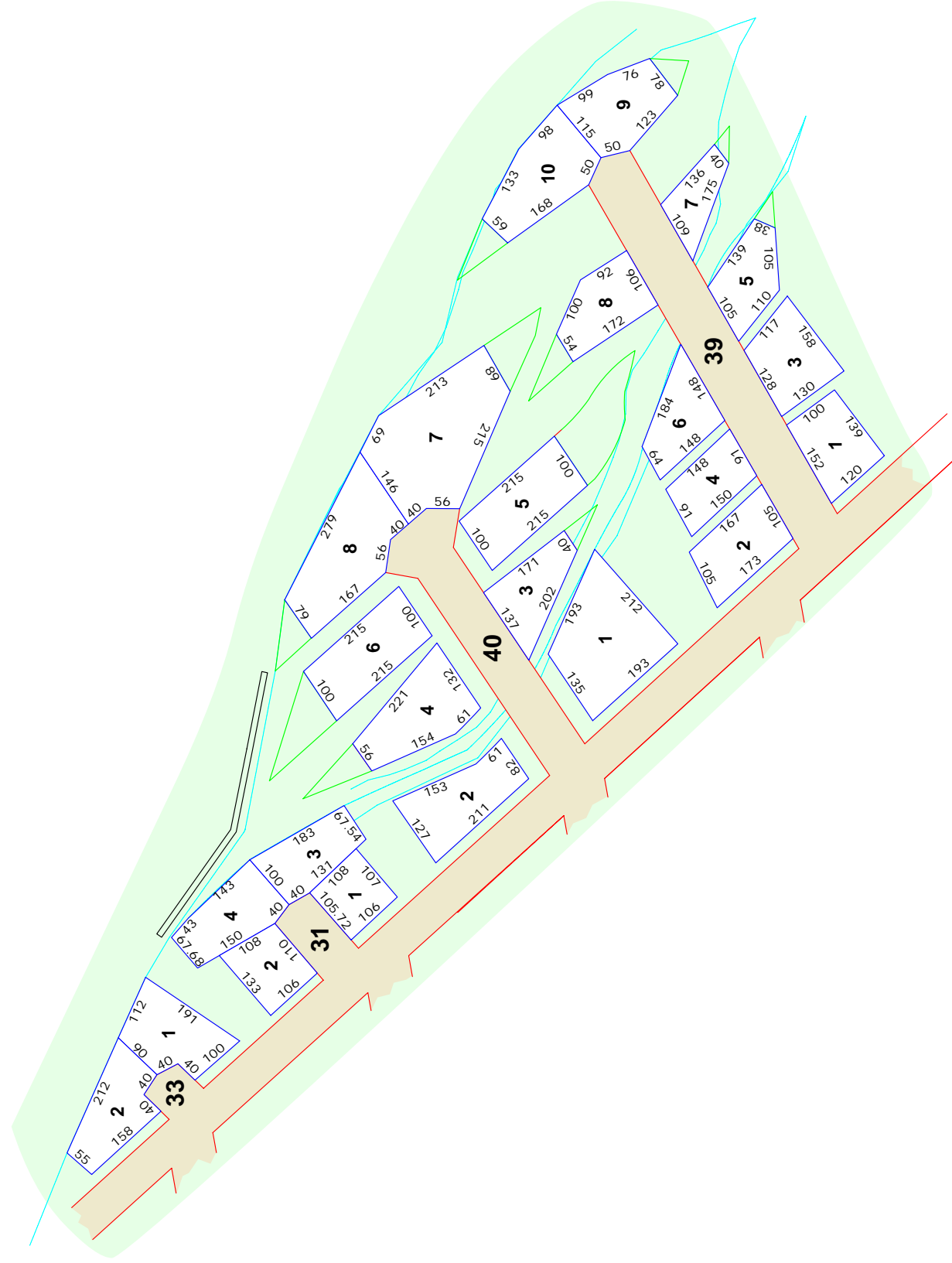

## HACIENDA DEL SOL

7400 - SECTION VB  
4Q-2005 • 24



THIS MAP IS FOR GENERAL LOT LOCATION USE ONLY  
ARCHITECT - JORGE PONCE © • ARTWORK® - BOB SKYE  
COPY BY WRITTEN PERMISSION ONLY

